

PLAN
SCALE: FULL SIZE

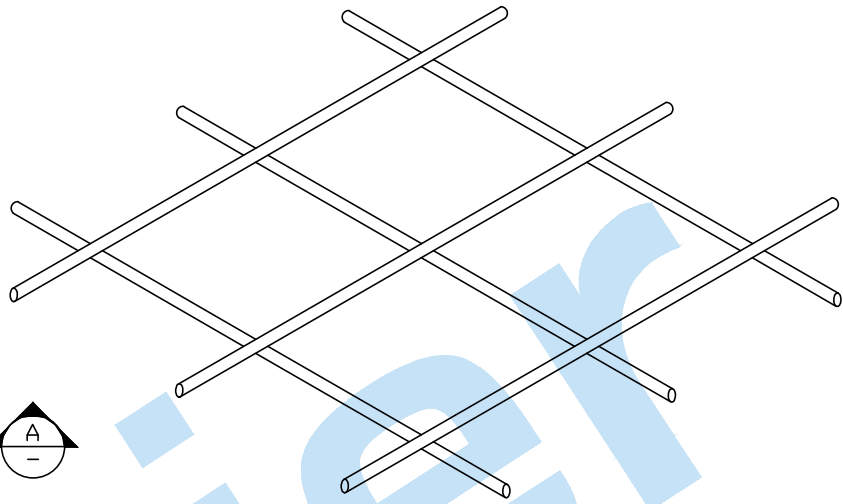

ISOMETRIC
SCALE: FULL SIZE

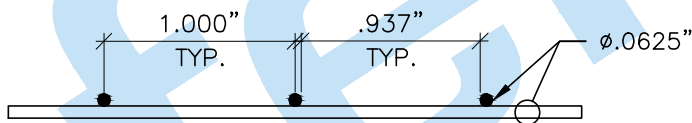

SECTION
SCALE: FULL SIZE

WELDMESH

DESCRIPTION: 1x1 MESH x .0625" DIA. WIRE
 CONSTRUCTION: RESISTANCE SPOT WELDED
 MATERIAL: 304 STAINLESS STEEL, GALVANIZED, CUSTOM
 MESH COUNT: 1x1 MESH (1"x1" CENTRES/25.4mmx25.4mm CENTRES)
 WIRE DIA.: .0625" (1.59mm)
 CLEAR OPENING: .9375" (23.8mm)
 % OPEN AREA: 87.8
 WEIGHT: 25.8lbs/csf (FOR STAINLESS STEEL)
 TOLERANCES DEPEND ON MATERIAL AND SOURCE
 MILL TEST REPORT AVAILABLE ON REQUEST

PRODUCT: 1x1 MESH x .0625" DIA. WIRE WELDMESH

Project No. FW-05	Date: JUNE 23, 2016	Drawn By: RR
Drawing No. S5	Rev:	Checked By: MW

ferrier

WIRE GOODS COMPANY LTD. • SINCE 1912

170 Mulock Avenue
Toronto, ON M6N 3C8

Tel: 416-769-5280
 Fax: 416-769-2232
 Toll Free: 888-769-5280

info@ferrierwire.com
 www.ferrierwire.com